

## MPLC1040L2R2

Aliases (UPID1040L2R200)

Not for New Design

KEMET, MPLC, Metal Composite, 20%, 2,200 nH, 4539

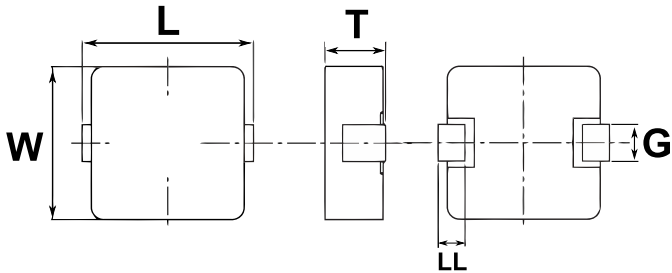

Click [here](#) for the 3D model.

Dimensions	
Chip Size	4539
L	11.5mm MAX
W	10mm +/-0.2mm
T	4mm MAX
G	4mm +/-0.1mm

Packaging Specifications	
Packaging	T&R, 330mm
Packaging Quantity	500

General Information	
Series	MPLC
Style	SMD Molded
Core	Metal Composite
Description	Shielded, Surface Mount Inductor
Features	Large Current Inductors
RoHS	Yes

Specifications	
Inductance	2.2 uH (0.1 MHz)
Inductance Tolerance	20%
Rated Current	10.5 Amps (Irms, 40C Rise By Self Heating)
Saturation Current	11 Amps (Isat, 20% Drop In Inductance)
Temperature Range	-40/+125°C
Shielded	Yes
DC Resistance	10 mOhms
DC Resistance	10 mOhms

Statements of suitability for certain applications are based on our knowledge of typical operating conditions for such applications, but are not intended to constitute - and we specifically disclaim - any warranty concerning suitability for a specific customer application or use. This Information is intended for use only by customers who have the requisite experience and capability to determine the correct products for their application. Any technical advice inferred from this Information or otherwise provided by us with reference to the use of our products is given gratis, and we assume no obligation or liability for the advice given or results obtained.