



a YAGEO company

ERP610W222KYGO

Aliases (C835YG222K760X, ERP610VH4220KYGO)

Obsolete

ERP610 SFTY X1-760 Y1-500, Ceramic, 2200 pF, 10%, 760 VAC (X1), 500 VAC (Y1), Y5U, 12.5mm

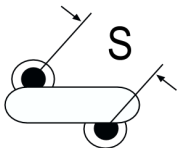
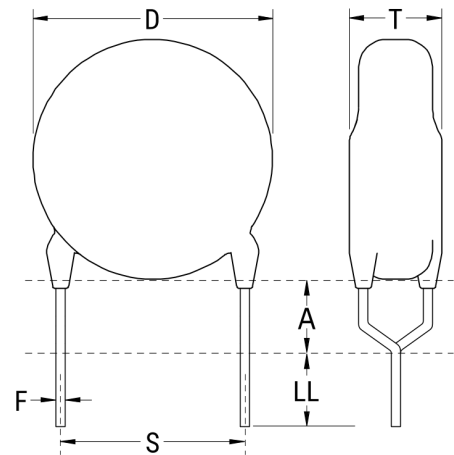

The measurement position of Lead Spacing (S) and Width (V) is critical in straight lead capacitors.

Click [here](#) for the 3D model.

Dimensions	
D	12mm MAX
T	5mm MAX
S	12.5mm NOM
LL	2.8mm +1.5mm
F	0.6mm +/-0.05mm
A	6mm MAX
V	2.1mm +/-0.5mm

Packaging Specifications	
Packaging	Bulk, Bag

General Information	
Series	ERP610 SFTY X1-760 Y1-500
Style	Radial Disc
Description	Ceramic Single Layer Safety Disc Capacitors
RoHS	Yes
Termination	Tin
Qualifications	UL, CSA, CAN, ENEC, VDE
AEC-Q200	No

Specifications	
Capacitance	2200 pF
Capacitance Tolerance	10%
Voltage AC	760 VAC (X1), 500 VAC (Y1)
Temperature Range	-40/+125°C
Temperature Coefficient	Y5U
Dissipation Factor	2.5%
Insulation Resistance	10 GOhms
Safety Class	X1/Y1

Statements of suitability for certain applications are based on our knowledge of typical operating conditions for such applications, but are not intended to constitute - and we specifically disclaim - any warranty concerning suitability for a specific customer application or use. This Information is intended for use only by customers who have the requisite experience and capability to determine the correct products for their application. Any technical advice inferred from this Information or otherwise provided by us with reference to the use of our products is given gratis, and we assume no obligation or liability for the advice given or results obtained.